



The development process for the Campbell Cradle Grab Hook employed a rigorous design approach that involved Finite Element Analysis (FEA) and repeated prototype testing to develop the strongest hook solution possible. The precise shape of the cradle is designed to keep the captured center link suspended slightly above the bowl of the hook to eliminate side-loading while the shoulders support the adjacent link to maximize chain strength. The result is a Best-in-Class Grab Hook that outperforms the competition, eliminating the 20% working load limit reduction requirement for choking applications. That's Campbell Confidence at work.



- Superior design retains 100% of working load when used in choking applications
- 4:1 design factor; meets or exceeds all requirements for ASME B30.9 and B30.10
- Fatigue and 100% proof tested in accordance with ASTM A952
- For use with all Grade 100 chain slings
- Made in USA to support American jobs and provide US-made quality assurance
- Forged hallmarks include date code, size, grade, "Campbell," and "USA".



www.campbellchainandfittings.com

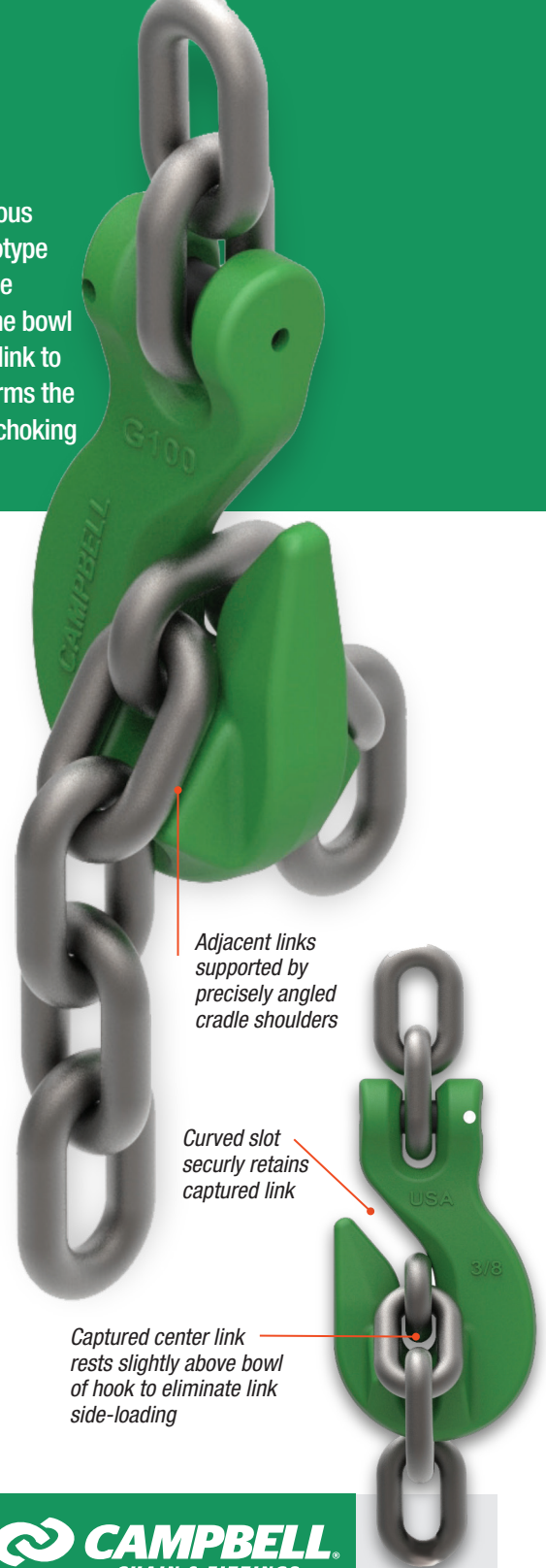

Chain Size		Cat. No.	Working Load Limit	
in.	mm		lb.	kg
9/32-5/16	7-8	5726415	5,700	2,600
3/8	10	5726615	8,800	4,000
1/2	13	5726815	15,000	6,800
5/8	16	5727015	22,600	10,300

Apex Tool Group, LLC
14600 York Road, Suite A
Sparks, Maryland 21152
www.apextoolgroup.com

ATG-2093 T550950
©2015 Apex Tool Group, LLC
CAMPBELL® is a registered trademark of Apex Brands, Inc., a Division of Apex Tool Group, LLC.

Campbell Cradle Grab Hook

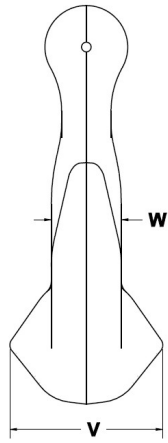
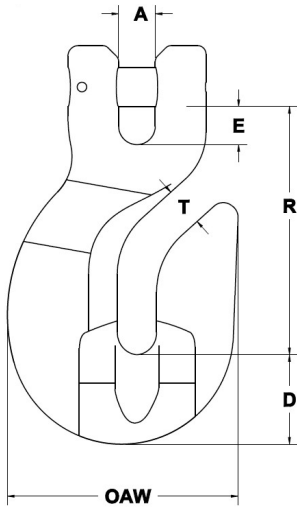

Trade Size	Trade Size	Cat. No.	A Dim.	D Dim.	E Dim.	Load Pin Dia.	OAW	R Dim.	T Dim.	W Dim.	V Dim.
9/32 - 5/16 in	7-8 mm	5726415	11/32 in	27/32 in	3/8 in	3/8 in	2-9/32 in	2-23/32 in	7/16 in	3/4 in	1-15/32 in
3/8 in	10 mm	5726615	15/32 in	1-9/32 in	15/32 in	1/2 in	2-31/32 in	3-3/16 in	17/32 in	13/16 in	2-1/32 in
1/2 in	13 mm	5726815	5/8 in	1-15/32 in	19/32 in	5/8 in	3-11/16 in	4-1/4 in	23/32 in	1-1/16 in	2-13/32 in
5/8 in	16 mm	5727015	23/32 in	1-3/4 in	3/4 in	3/4 in	4-17/32 in	4-27/32 in	25/32 in	1-3/8 in	3 in

